

**J2 FMM INTERFACE
DEUTSCH DT04-12PA
W12P**

TERMINAL	WIRE	WIRE SIZE
1	N/A	N/A
2	ORN	18 AWG TXL
3	WHT	18 AWG TXL
4	BLU/RED	18 AWG TXL
5	BLU/WHT	18 AWG TXL
6	GRY/BLU	18 AWG TXL
7	N/A	N/A
8	YEL/BLU	18 AWG TXL
9	YEL/RED	18 AWG TXL
10	WHT	18 AWG TXL
11	PRP	18 AWG TXL
12	N/A	N/A

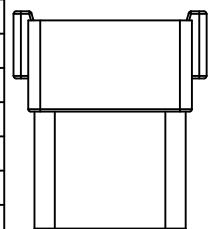
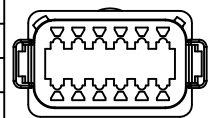

4.0"

**P5 CHASSIS INTERFACE
DEUTSCH DT06-12SA
W12S**

TERMINAL	WIRE	WIRE SIZE
1	N/A	N/A
2	ORN	18 AWG TXL
3	WHT	18 AWG TXL
4	BLU/RED	18 AWG TXL
5	BLU/WHT	18 AWG TXL
6	N/A	N/A
7	N/A	N/A
8	YEL/BLU	18 AWG TXL
9	YEL/RED	18 AWG TXL
10	WHT	18 AWG TXL
11	PRP	18 AWG TXL
12	N/A	N/A

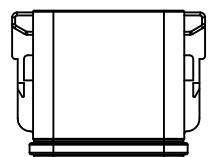
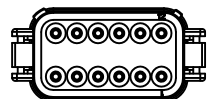

4.0"

REVISION HISTORY

ZONE	REV	DESCRIPTION	APPROVED	DATE
B3	A	CORRECTED TABLE	cbc	2/14/2017
B6	B	CORRECTED PART NUMBER	cbc	2/15/2017



4.0"

**P2 FLIM
DELPHI 12015798**

TERMINAL	WIRE	WIRE SIZE
A	ORN	18 AWG TXL
B	GRY/YEL	18 AWG TXL
C	WHT	18 AWG TXL
D	BLU	18 AWG TXL

**P1 ECU
DELPHI 12129225 W/
STRAIN RELF 21260848**

TERMINAL	WIRE	WIRE SIZE
1	N/A	N/A
2	ORN	18 AWG TXL
3	N/A	N/A
4	N/A	N/A
5	BLU/WHT	18 AWG TXL
6	N/A	N/A
7	N/A	N/A
8	GRN	18 AWG TXL
9	YEL	18 AWG TXL
10	BLK	18 AWG TXL
11	GRY/BLU	18 AWG TXL
12	GRY/BLK	18 AWG TXL
13	ORN	18 AWG TXL
14	WHT	18 AWG TXL
15	GRY	18 AWG TXL
16	BLU/RED	18 AWG TXL
17	N/A	N/A
18	N/A	N/A
19	N/A	N/A
20	WHT/RED	18 AWG TXL
21	N/A	N/A
22	GRY/ORN	18 AWG TXL
23	BRN	18 AWG TXL
24	GRY/YEL	18 AWG TXL

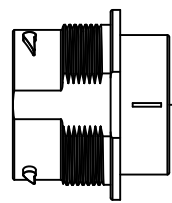
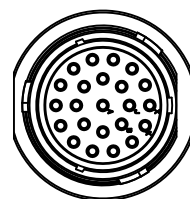

6.0"

2.0"

2.0"

4.0"

2.0"

2.0"

2.0"

J1 CHASSIS INTERFACE DEUTSCH HDP24-24-23PN

TERMINAL	WIRE	WIRE SIZE	TERMINAL	WIRE	WIRE SIZE
A	N/A	N/A	N	N/A	N/A
B	ORN	18 AWG TXL	D	WHT	18 AWG TXL
C	PRP	18 AWG TXL	P	N/A	N/A
D	YEL/RED	18 AWG TXL	Q	YEL/BLU	18 AWG TXL
E	N/A	N/A	R	N/A	N/A
F	BLU	18 AWG TXL	S	N/A	N/A
G	N/A	N/A	T	BLK	18 AWG TXL
H	GRN	18 AWG TXL	U	WHT/RED	18 AWG TXL
J	YEL	18 AWG TXL	V	N/A	N/A
K	N/A	N/A	W	N/A	N/A
L	GRY	18 AWG TXL	X	BRN	18 AWG TXL
M	N/A	N/A			

4.0"

4.0"

4.0"

5.0"

**J3 TERMINATING
RESISTOR
DEUTSCH DT04-3P**

TERMINAL	WIRE	WIRE SIZE
A	YEL	18 AWG TXL
B	GRN	18 AWG TXL
C	N/A	N/A

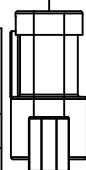

**P4 FUEL RELAY
DELPHI 12065686**

TERMINAL	WIRE	WIRE SIZE
30	ORN	18 AWG TXL
85	ORN	18 AWG TXL
86	GRY/ORN	18 AWG TXL
87A	N/A	N/A
87	YEL/BLU	18 AWG TXL

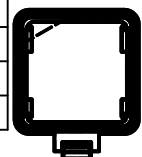

**P3 STARTER RELAY
DELPHI 12065686**

TERMINAL	WIRE	WIRE SIZE
30	YEL/RED	18 AWG TXL
85	YEL/RED	18 AWG TXL
86	GRY/BLK	18 AWG TXL
87A	N/A	N/A
87	PRP	18 AWG TXL

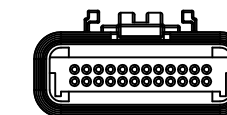
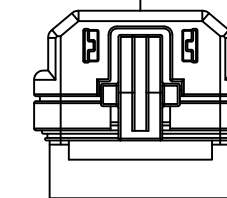
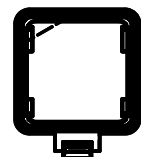

NOTES:

- HARNESS TO BE BRAIDED WITH VN4400S OR EQUIVALENT PVC COATED YARN**
- USE WITH VERTICAL FMM W/ ELECTRONICS**

CONFIDENTIAL AND TRADE SECRET INFORMATION OF NATURAL GAS FUEL SYSTEMS, INC. dba MOMENTUM FUEL TECHNOLOGIES
This document and the information in it is confidential, proprietary and trade secret information of Natural Gas Fuel Systems, Inc. dba Momentum Fuel Technologies on behalf of itself and its subsidiaries and affiliates ("Momentum"). It contains information intended only for the person to whom it is transmitted and may not be disclosed to any third party, in whole or in part, or used to manufacture anything shown or referred to herein, without Momentum's express, written permission. This document must be returned to Momentum on request.

Any form of reproduction, dissemination, copying, disclosure, modification, distribution, and or publication of this document and the information contained herein is strictly prohibited.

This notice must appear on any complete or partial reproduction of this document or the information contained herein.

Copyright © 2016 Natural Gas Fuel Systems, Inc. dba Momentum Fuel Technologies. All rights reserved.

ALL DIMENSION TOLERANCES UNLESS NOTED
ONE PLACE .X ±.06
TWO PLACES .XX ±.03
THREE PLACES .XXX ±.010
FOUR PLACES .XXXX ±.0010
ALL MACHINED SURFACES TO BE 250 RMS UNLESS NOTED.



DO NOT SCALE THIS PRINT

DRAWN brummern	1/31/2017	MOMENTUM FUEL TECHNOLOGIES 1051 Republic Drive, Suite 200 Roanoke, TX 76262	
CHECKED culbersonc	2/13/2017	TITLE HARNESS- ELECTRONICS HEIL VERTICAL FMM	
QA		SIZE D	DWG NO MP92-1027
MFG		SCALE	REV B
APPROVED Part Mass	2/13/17	SHEET 1 OF 2	

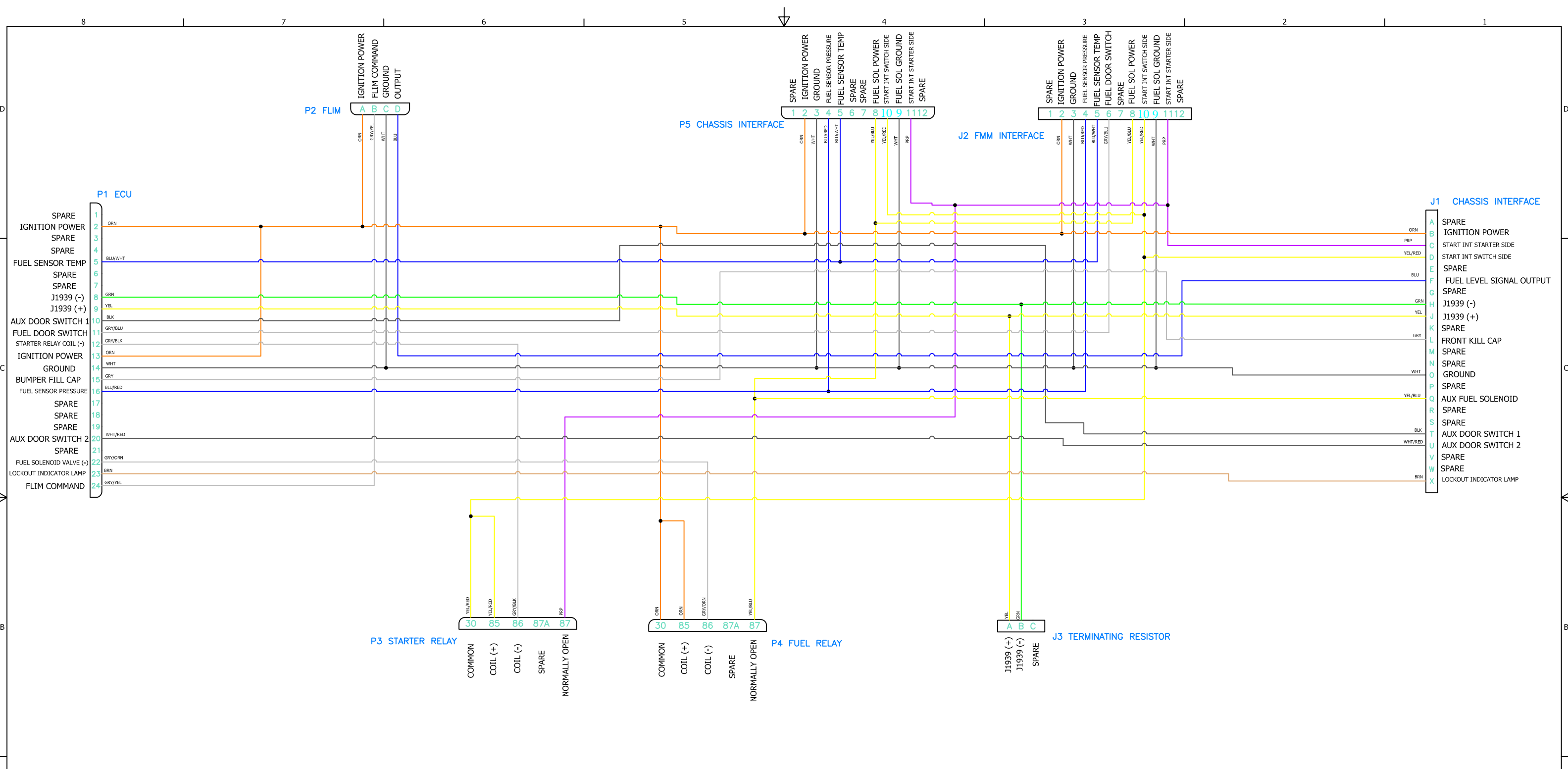

CONFIDENTIAL AND TRADE SECRET INFORMATION OF NATURAL GAS FUEL SYSTEMS, INC. dba MOMENTUM FUEL TECHNOLOGIES
 This document and the information in it is confidential, proprietary and trade secret information of Natural Gas Fuel Systems, Inc. dba Momentum Fuel Technologies on behalf of itself and its subsidiaries and affiliates ("Momentum"). It contains information intended only for the person to whom it is transmitted and may not be disclosed to any third party, in whole or in part, or used to manufacture anything shown or referred to herein, without Momentum's express, written permission. This document must be returned to Momentum on request.

Any form of reproduction, dissemination, copying, disclosure, modification, distribution, and or publication of this document and the information contained herein is strictly prohibited.

This notice must appear on any complete or partial reproduction of this document or the information contained herein.

Copyright © 2016 Natural Gas Fuel Systems, Inc. dba Momentum Fuel Technologies. All rights reserved.

ALL DIMENSION TOLERANCES UNLESS NOTED
 ONE PLACE .X ±.06
 TWO PLACES .XX ±.03
 THREE PLACES .XXX ±.010
 FOUR PLACES .XXXX ±.0010
 ALL MACHINED SURFACES TO BE 250 RMS UNLESS NOTED.

I
 DO NOT SCALE THIS PRINT

- NOTES:**
- HARNES TO BE BRAIDED WITH VN4400S OR EQUIVALENT PVC COATED YARN**
 - USE WITH VERTICAL FMM W/ ELECTRONICS**

DRAWN brummern	1/31/2017	MOMENTUM FUEL TECHNOLOGIES 1051 Republic Drive, Suite 200 Roanoke, TX 76262		
CHECKED culbersonc	2/13/2017			
QA		HARNES- ELECTRONICS HEIL VERTICAL FMM		
MFG culbersonc	2/13/2017			
APPROVED		SIZE D	DWG NO MP92-1027	REV B
Part Mass		SCALE		SHEET 2 OF 2