

**J2 FMM INTERFACE  
DEUTSCH DT04-12PA  
W12P**

TERMINAL	WIRE	WIRE SIZE
1	N/A	N/A
2	ORN	18 AWG TXL
3	WHT	18 AWG TXL
4	BLU/RED	18 AWG TXL
5	BLU/WHT	18 AWG TXL
6	GRY/BLU	18 AWG TXL
7	N/A	N/A
8	YEL/BLU	18 AWG TXL
9	WHT	18 AWG TXL
10	YEL/RED	18 AWG TXL
11	PRP	18 AWG TXL
12	N/A	N/A

**P5 PLUG  
DEUTSCH  
DT04-12PA AND  
SEALS**

**P5 CHASSIS INTERFACE  
DEUTSCH DT06-12SA  
W12S**

TERMINAL	WIRE	WIRE SIZE
1	N/A	N/A
2	ORN	18 AWG TXL
3	WHT	18 AWG TXL
4	BLU/RED	18 AWG TXL
5	BLU/WHT	18 AWG TXL
6	N/A	N/A
7	N/A	N/A
8	YEL/BLU	18 AWG TXL
9	WHT	18 AWG TXL
10	YEL/RED	18 AWG TXL
11	PRP	18 AWG TXL
12	N/A	N/A

**P2 FLIM  
DELPHI 12015798**

TERMINAL	WIRE	WIRE SIZE
A	ORN	18 AWG TXL
B	GRY/YEL	18 AWG TXL
C	WHT	18 AWG TXL
D	BLU	18 AWG TXL

**P1 ECU  
DELPHI 12129225 W/  
STRAIN RELF 21260848**

TERMINAL	WIRE	WIRE SIZE
1	N/A	N/A
2	ORN	18 AWG TXL
3	N/A	N/A
4	N/A	N/A
5	BLU/WHT	18 AWG TXL
6	N/A	N/A
7	N/A	N/A
8	GRN	18 AWG TXL
9	YEL	18 AWG TXL
10	BLK	18 AWG TXL
11	GRY/BLU	18 AWG TXL
12	GRY/BLK	18 AWG TXL
13	ORN	18 AWG TXL
14	WHT	18 AWG TXL
15	GRY	18 AWG TXL
16	BLU/RED	18 AWG TXL
17	GRY/RED	18 AWG TXL
18	N/A	N/A
19	N/A	N/A
20	WHT/RED	18 AWG TXL
21	N/A	N/A
22	GRY/ORN	18 AWG TXL
23	BRN	18 AWG TXL
24	GRY/YEL	18 AWG TXL

**J1 PLUG DEUTSCH  
HDC26-24**

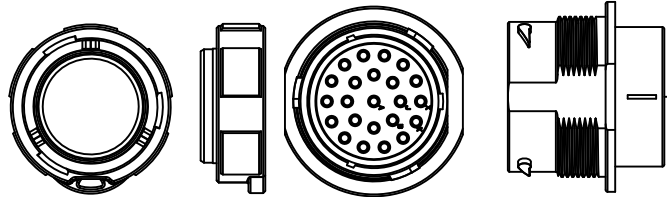

**J1 CHASSIS INTERFACE DEUTSCH HDP24-24-23PN**

TERMINAL	WIRE	WIRE SIZE	TERMINAL	WIRE	WIRE SIZE
A	N/A	N/A	N	N/A	
B	ORN	18 AWG TXL	D	WHT	18 AWG TXL
C	YEL/RED	18 AWG TXL	P	N/A	N/A
D	PRP	18 AWG TXL	Q	YEL/BLU	18 AWG TXL
E	N/A	N/A	R	GRY/RED	18 AWG TXL
F	BLU	18 AWG TXL	S	N/A	N/A
G	N/A	N/A	T	BLK	18 AWG TXL
H	GRN	18 AWG TXL	U	WHT/RED	18 AWG TXL
J	YEL	18 AWG TXL	V	N/A	N/A
K	N/A	N/A	W	N/A	N/A
L	GRY	18 AWG TXL	X	BRN	18 AWG TXL
M	N/A	N/A			

**J3 TERMINATING  
RESISTOR  
DEUTSCH DT04-3P**

TERMINAL	WIRE	WIRE SIZE
A	YEL	18 AWG TXL
B	GRN	18 AWG TXL
C	N/A	N/A

**J3 PLUG DEUTSCH  
DT06-3S AND  
SEALS**

**P4 FUEL RELAY  
DELPHI 12065686**

TERMINAL	WIRE	WIRE SIZE
30	ORN	18 AWG TXL
85	ORN	18 AWG TXL
86	GRY/ORN	18 AWG TXL
87A	N/A	N/A
87	YEL/BLU	18 AWG TXL

**P3 STARTER RELAY  
DELPHI 12065686**

TERMINAL	WIRE	WIRE SIZE
30	YEL/RED	18 AWG TXL
85	YEL/RED	18 AWG TXL
86	GRY/BLK	18 AWG TXL
87A	N/A	N/A
87	PRP	18 AWG TXL

**NOTES:**

- HARNESS TO BE BRAIDED WITH VN4400S OR EQUIVALENT PVC COATED YARN**
- USE WITH VERTICAL FMM W/ ELECTRONICS**
- REPLACES MP92-1027**

**CONFIDENTIAL AND TRADE SECRET INFORMATION OF NATURAL GAS FUEL SYSTEMS, INC. dba MOMENTUM FUEL TECHNOLOGIES**  
This document and the information in it is confidential, proprietary and trade secret information of Natural Gas Fuel Systems, Inc. dba Momentum Fuel Technologies on behalf of itself and its subsidiaries and affiliates ("Momentum"). It contains information intended only for the person to whom it is transmitted and may not be disclosed to any third party, in whole or in part, or used to manufacture anything shown or referred to herein, without Momentum's express, written permission. This document must be returned to Momentum on request.

Any form of reproduction, dissemination, copying, disclosure, modification, distribution, and or publication of this document and the information contained herein is strictly prohibited.

This notice must appear on any complete or partial reproduction of this document or the information contained herein.

Copyright © 2016 Natural Gas Fuel Systems, Inc. dba Momentum Fuel Technologies. All rights reserved.

ALL DIMENSION TOLERANCES UNLESS NOTED  
 ONE PLACE .X ±.06  
 TWO PLACES .XX ±.03  
 THREE PLACES .XXX ±.010  
 FOUR PLACES .XXXX ±.0010  
 ALL MACHINED SURFACES TO BE 250 RMS UNLESS NOTED.



DO NOT SCALE THIS PRINT

DRAWN brummern	5/4/2017	MOMENTUM FUEL TECHNOLOGIES 1051 Republic Drive, Suite 200 Roanoke, TX 76262	
CHECKED CULBERSONC	5/5/2017	TITLE <b>HARNESS- ELECTRONICS VERTICAL FMM</b>	
QA			
MFG			
APPROVED CULBERSONC	5/5/2017	SIZE D	DWG NO MP92-1036
Part Mass		SCALE	REV
		SHEET 1 OF 2	

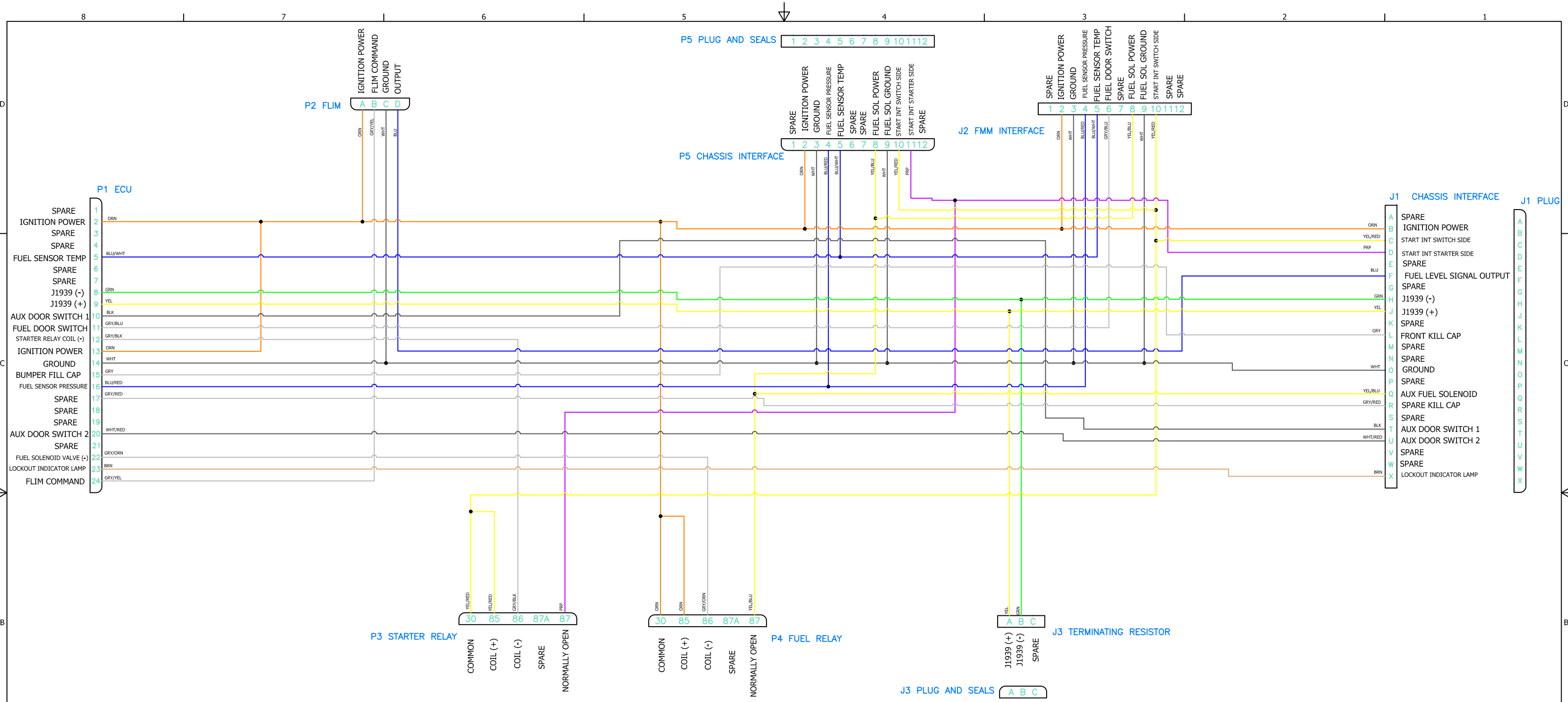

- NOTES:**
- HARNES TO BE BRAIDED WITH VN4400S OR EQUIVALENT PVC COATED YARN**
  - USE WITH VERTICAL FMM W/ ELECTRONICS**
  - REPLACES MP92-1027**

**CONFIDENTIAL AND TRADE SECRET INFORMATION OF NATURAL GAS FUEL SYSTEMS, INC. dba MOMENTUM FUEL TECHNOLOGIES**  
 This document and the information in it is confidential, proprietary and trade secret information of Natural Gas Fuel Systems, Inc. dba Momentum Fuel Technologies on behalf of itself and its subsidiaries and affiliates ("Momentum"). It contains information intended only for the person to whom it is transmitted and may not be disclosed to any third party, in whole or in part, or used to manufacture anything shown or referred to herein, without Momentum's express, written permission. This document must be returned to Momentum on request.

Any form of reproduction, dissemination, copying, disclosure, modification, distribution, and or publication of this document and the information contained herein is strictly prohibited.

This notice must appear on any complete or partial reproduction of this document or the information contained herein.

Copyright © 2016 Natural Gas Fuel Systems, Inc. dba Momentum Fuel Technologies. All rights reserved.

ALL DIMENSION TOLERANCES UNLESS NOTED  
 ONE PLACE .X ±.06  
 TWO PLACES .XX ±.03  
 THREE PLACES .XXX ±.010  
 FOUR PLACES .XXXX ±.0010  
 ALL MACHINED SURFACES TO BE 250 RMS UNLESS NOTED.



DO NOT SCALE THIS PRINT

DRAWN brummern	5/4/2017	MOMENTUM FUEL TECHNOLOGIES 1051 Republic Drive, Suite 200 Roanoke, TX 76262	
CHECKED CULBERSONC	5/5/2017		
QA		TITLE <b>HARNES- ELECTRONICS VERTICAL FMM</b>	
MFG			
APPROVED CULBERSONC	5/5/2017	SIZE D	DWG NO MP92-1036
Part Mass		SCALE	REV
		SHEET 2 OF 2	