

**J2 FMM INTERFACE
DEUTSCH DT04-12PA
W12P**

TERMINAL	WIRE	WIRE SIZE
1	N/A	N/A
2	ORN	18 AWG TXL
3	WHT	18 AWG TXL
4	BLU/RED	18 AWG TXL
5	BLU/WHT	18 AWG TXL
6	GRY/BLU	18 AWG TXL
7	N/A	N/A
8	YEL/BLU	18 AWG TXL
9	WHT	18 AWG TXL
10	YEL/RED	18 AWG TXL
11	N/A	N/A
12	N/A	N/A

**P5 PLUG
DEUTSCH
DT04-12PA AND
SEALS**

**P5 CHASSIS INTERFACE
DEUTSCH DT06-12SA
W12S**

TERMINAL	WIRE	WIRE SIZE
1	N/A	N/A
2	ORN	18 AWG TXL
3	WHT	18 AWG TXL
4	BLU/RED	18 AWG TXL
5	BLU/WHT	18 AWG TXL
6	N/A	N/A
7	N/A	N/A
8	YEL/BLU	18 AWG TXL
9	WHT	18 AWG TXL
10	YEL/RED	18 AWG TXL
11	PRP	18 AWG TXL
12	N/A	N/A

**P6 J1939 CAN 1
DEUTSCH DT06-3S**

TERMINAL	WIRE	WIRE SIZE
A	YEL/BRN	18 AWG TXL
B	GRN/BRN	18 AWG TXL
C	N/A	N/A

**P1 ECU
DELPHI 12129225 W/
STRAIN RELF 12160848**

TERMINAL	WIRE	WIRE SIZE
1	N/A	N/A
2	ORN	18 AWG TXL
3	N/A	N/A
4	N/A	N/A
5	BLU/WHT	18 AWG TXL
6	GRN/ORN	18 AWG TXL
7	YEL/ORN	18 AWG TXL
8	GRN/BRN	18 AWG TXL
9	YEL/BRN	18 AWG TXL
10	BLK	18 AWG TXL
11	GRY/BLU	18 AWG TXL
12	GRY/BLK	18 AWG TXL
13	ORN	18 AWG TXL
14	WHT	18 AWG TXL
15	GRY	18 AWG TXL
16	BLU/RED	18 AWG TXL
17	GRY/RED	18 AWG TXL
18	N/A	N/A
19	N/A	N/A
20	WHT/RED	18 AWG TXL
21	N/A	N/A
22	GRY/ORN	18 AWG TXL
23	BRN	18 AWG TXL
24	GRY/YEL	18 AWG TXL

**P2 FLIM
DELPHI 12015798**

TERMINAL	WIRE	WIRE SIZE
A	ORN	18 AWG TXL
B	GRY/YEL	18 AWG TXL
C	WHT	18 AWG TXL
D	BLU	18 AWG TXL

**P7 J1939 CAN 2
DEUTSCH DT06-3S**

TERMINAL	WIRE	WIRE SIZE
A	YEL/ORN	18 AWG TXL
B	GRN/ORN	18 AWG TXL
C	N/A	N/A

**J1 PLUG DEUTSCH
HDC26-24**

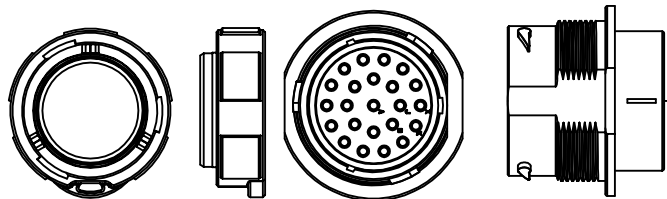

J1 CHASSIS INTERFACE DEUTSCH HDP24-24-23PE

TERMINAL	WIRE	WIRE SIZE	TERMINAL	WIRE	WIRE SIZE
A	N/A	N/A	N	N/A	N/A
B	ORN	18 AWG TXL	D	WHT	18 AWG TXL
C	YEL/RED	18 AWG TXL	P	N/A	N/A
D	PRP	18 AWG TXL	Q	YEL/BLU	18 AWG TXL
E	N/A	N/A	R	GRY/RED	18 AWG TXL
F	BLU	18 AWG TXL	S	N/A	N/A
G	N/A	N/A	T	BLK	18 AWG TXL
H	GRN	18 AWG TXL	U	WHT/RED	18 AWG TXL
J	YEL	18 AWG TXL	V	N/A	N/A
K	N/A	N/A	W	N/A	N/A
L	GRY	18 AWG TXL	X	BRN	18 AWG TXL
M	N/A	N/A			

**P4 FUEL RELAY
DELPHI 12066033**

TERMINAL	WIRE	WIRE SIZE
30	ORN	18 AWG TXL
85	ORN	18 AWG TXL
86	GRY/ORN	18 AWG TXL
87A	N/A	N/A
87	YEL/BLU	18 AWG TXL

**P3 STARTER RELAY
DELPHI 12066033**

TERMINAL	WIRE	WIRE SIZE
30	YEL/RED	18 AWG TXL
85	YEL/RED	18 AWG TXL
86	GRY/BLK	18 AWG TXL
87A	N/A	N/A
87	PRP	18 AWG TXL

**J3 J1939 TO
BULKHEAD
DEUTSCH DT04-3P**

TERMINAL	WIRE	WIRE SIZE
A	YEL	18 AWG TXL
B	GRN	18 AWG TXL
C	N/A	N/A

NOTES:

- HARNES TO BE BRAIDED WITH VN4400S OR EQUIVALENT PVC COATED YARN**
- USE WITH VERTICAL FMM W/ ELECTRONICS**
- REPLACES MP92-1036**
- ALL WIRES TO BE 18 AWG TXL**
- PLUG ALL UNUSED CONNECTORS**



DO NOT SCALE THIS PRINT

CONFIDENTIAL AND TRADE SECRET INFORMATION OF NATURAL GAS FUEL SYSTEMS, INC. dba MOMENTUM FUEL TECHNOLOGIES

This document and the information in it is confidential, proprietary and trade secret information of Natural Gas Fuel Systems, Inc. dba Momentum Fuel Technologies on behalf of itself and its subsidiaries and affiliates ("Momentum"). It contains information intended only for the person to whom it is transmitted and may not be disclosed to any third party, in whole or in part, or used to manufacture anything shown or referred to herein, without Momentum's express, written permission. This document must be returned to Momentum on request.

Any form of reproduction, dissemination, copying, disclosure, modification, distribution, and or publication of this document and the information contained herein is strictly prohibited.

This notice must appear on any complete or partial reproduction of this document or the information contained herein.

Copyright © 2016 Natural Gas Fuel Systems, Inc. dba Momentum Fuel Technologies. All rights reserved.

ALL DIMENSION TOLERANCES UNLESS NOTED
 ONE PLACE .X ±.06
 TWO PLACES .XX ±.03
 THREE PLACES .XXX ±.010
 FOUR PLACES .XXXX ±.0010
 ALL MACHINED SURFACES TO BE 250 RMS UNLESS NOTED.

DRAWN brummern	9/19/2019	MOMENTUM FUEL TECHNOLOGIES 1051 Republic Drive, Suite 200 Roanoke, TX 76262	
CHECKED		TITLE HARNES- ELECTRONICS VERTICAL FMM	
QA		SIZE D	DWG NO MP92-1632
MFG		SCALE	REV
APPROVED		SHEET 1 OF 2	
Part Mass			

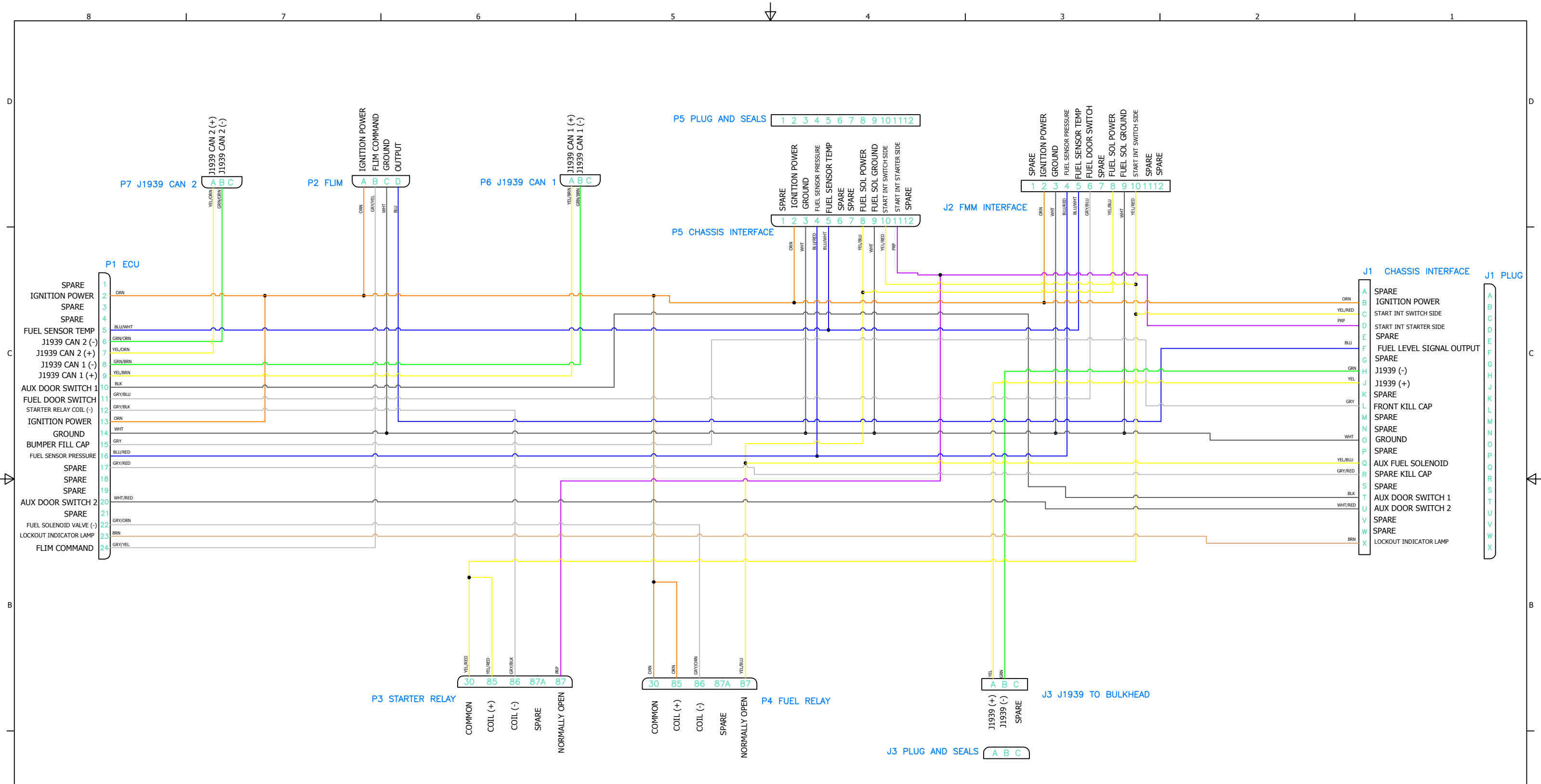

CONFIDENTIAL AND TRADE SECRET INFORMATION OF NATURAL GAS FUEL SYSTEMS, INC. dba MOMENTUM FUEL TECHNOLOGIES
 This document and the information in it is confidential, proprietary and trade secret information of Natural Gas Fuel Systems, Inc. dba Momentum Fuel Technologies on behalf of itself and its subsidiaries and affiliates ("Momentum"). It contains information intended only for the person to whom it is transmitted and may not be disclosed to any third party, in whole or in part, or used to manufacture anything shown or referred to herein, without Momentum's express, written permission. This document must be returned to Momentum on request.

Any form of reproduction, dissemination, copying, disclosure, modification, distribution, and or publication of this document and the information contained herein is strictly prohibited.

This notice must appear on any complete or partial reproduction of this document or the information contained herein.

Copyright © 2016 Natural Gas Fuel Systems, Inc. dba Momentum Fuel Technologies. All rights reserved.

ALL DIMENSION TOLERANCES UNLESS NOTED
 ONE PLACE .X ±.06
 TWO PLACES .XX ±.03
 THREE PLACES .XXX ±.010
 FOUR PLACES .XXXX ±.0010
 ALL MACHINED SURFACES TO BE 250 RMS UNLESS NOTED.



DO NOT SCALE THIS PRINT

DRAWN brummern	9/19/2019	MOMENTUM FUEL TECHNOLOGIES 1051 Republic Drive, Suite 200 Roanoke, TX 76262	
CHECKED		TITLE HARNISS- ELECTRONICS VERTICAL FMM	
QA		SIZE D	DWG NO MP92-1632
MFG		SCALE	REV
APPROVED		SHEET 2 OF 2	
Part Mass			